

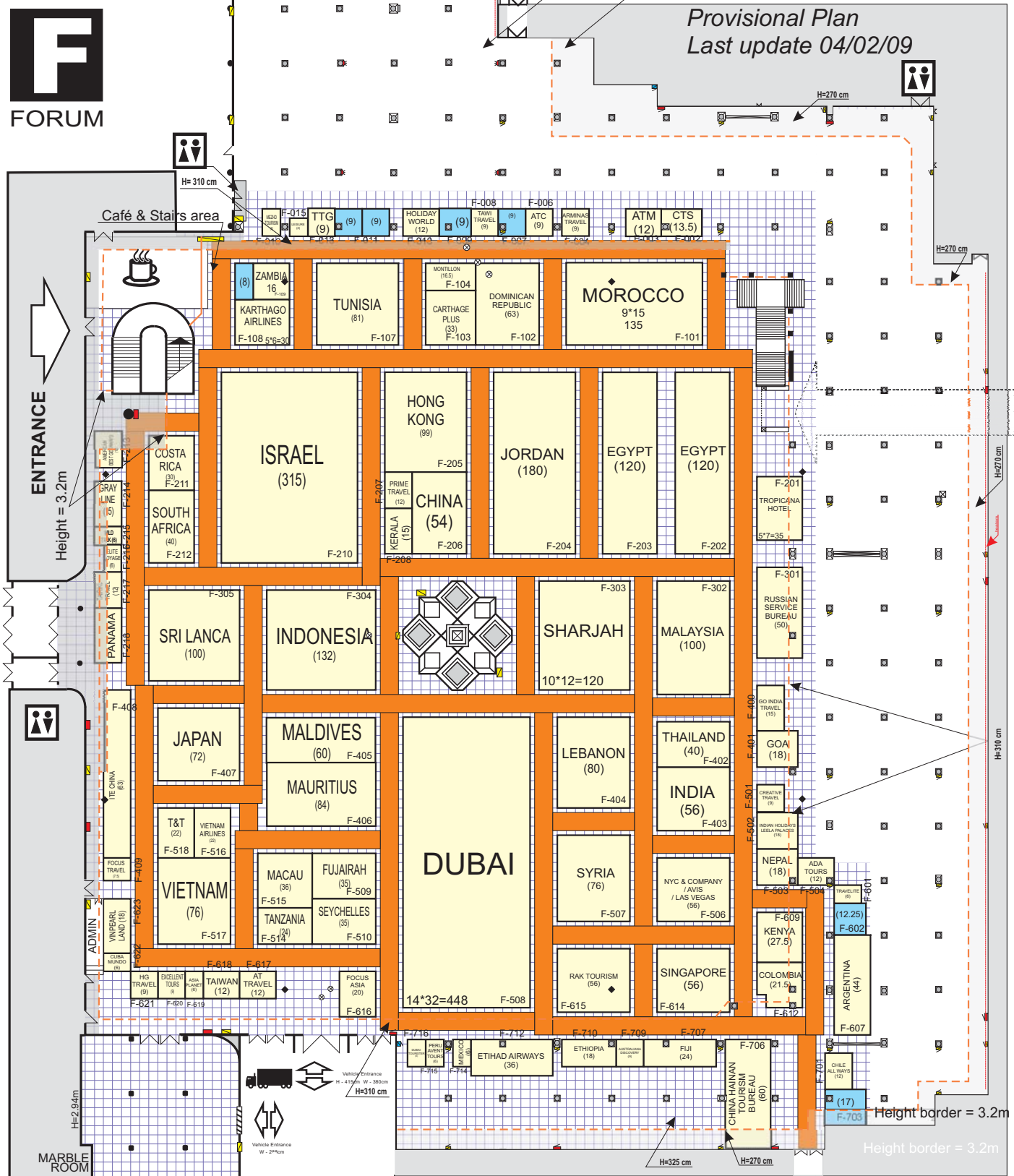

Pavilion



Provisional Plan
Last update 04/02/09



ENTRANCE FROM PAVILION 1

ENTRANCE
Height = 3.2m

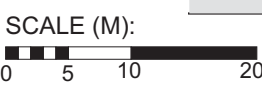

Ceiling Heights	
Maximum	1400cm
Minimum	270cm (under balcony)

Floor Loading	
Maximum	3000kg/m ²

	Fire Points
	Electrical box
	Water Drainage
	Water Connection
	Balcony
	Column

FAST TRACK VISITORS REGISTRATION

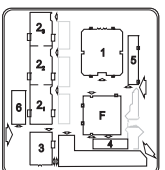

EMERGENCY EXIT

Height = 2.94m

Vehicle Entrance
H = 4.12m W = 980cm

Vehicle Entrance
W = 240cm

Height border = 3.2m

H=325 cm

H=270 cm

Height border = 3.2m

H=310 cm

H=270 cm

H=270 cm

Ceiling Heights
320 cm
250 cm

H=247 cm
H=317 cm
H=270 cm

Café & Stairs area
H=310 cm

Height = 3.2m

H=2.94m

EMERGENCY EXIT